

## Internal Designs

### General Purpose

Standard, free-flow internal design General Purpose Nozzle, provides minimum flow resistance and back pressure buildup; 1/2" diameter flow path unless otherwise stated.

### Nylon Reverse Taper

For use with polyamides, acrylics, and similar expansive and heat-sensitive materials. Material flows 1 1/2" through 1/8" diameter-restricted throat into 1" long reverse taper. Sprue breaks inside nozzle providing expansion area and reducing drool.

### Full Taper - ABS

For use with ABS, PVC and other viscous hard-flow materials. Reduces frictional heat and areas of hangup. Recommended large orifices for minimum flow resistance. Taper 3" longitudinal distance from rear opening to 1/2" internal bore.



**Hardened Chrome Vanadium tool steel for long life**

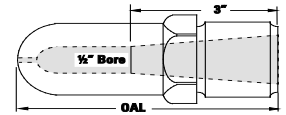
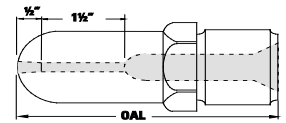
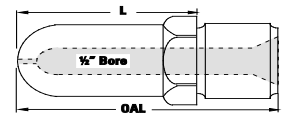

Description	Total Length
Thread dia. up to 2" (50mm)	5"
	6"
	7"
	8"
	9"
	10"
	12"
	14"
	16"
	18"
20"	

Description	Total Length
Thread dia. 2 1/8" to 2 3/4" (51mm to 69mm)	5"
	6"
	7"
	8"
	9"
	10"
	12"
	14"
	16"
	18"
20"	

Hardened Chrome Vanadium tool steel. Polished to mirror finish to provide smooth material flowpath. These nozzles will provide far greater life and superior flow characteristics than relatively soft, "T" - condition nozzles.



### How to Order:

1. Specify make and model of machine plus style of nozzle.
2. Specify radius and orifice. Options—TC hole on hex flat

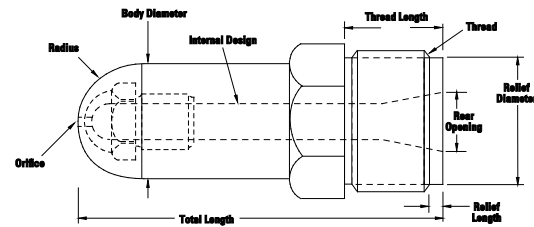

**Complete the information below and fax to DME at 248-544-5113) or email to DME@dme.net.**

1. Total Length	_____	6. Radius (Flat, 1/2", 3/4", 35 mm)	_____
2. Thread Length	_____	7. Orifice	_____
3. Thread Type (1 1/2" - 12 etc.)	_____	8. Internal Design (general purpose, nylon reverse taper or ABS full taper)	_____
4. Rear Openings	_____	9. Relief Diameter	_____
5. Body Diameter (1", 1 1/2", 2")	_____	10. Relief Length	_____
MACHINE MAKE:	_____	MODEL:	_____
		YEAR:	_____

Company: \_\_\_\_\_  
 Account Number: \_\_\_\_\_  
 Address: \_\_\_\_\_  
 City: \_\_\_\_\_  
 State/Zip: \_\_\_\_\_

Contact Name: \_\_\_\_\_  
 Phone: \_\_\_\_\_  
 Fax : \_\_\_\_\_  
 E-mail: \_\_\_\_\_

**SUBMIT**